

APPLICATIONS: Pre-installation in below locations and immediate operating will be helpful to prevent important areas from flooding.

- A. Public construction sites, such as tunnel and subway.
- B. Basement of buildings, to avoid damages/losses of property.
- C. Industries, to avoid damages of valuable equipment's and working spaces.

FEATURES

- 1. Discharges of guide rails are sized to 2", 3", 4", 6", 8" and suits to most of ranges.
- 2. Materials of Guide Rail are FT series/cast iron and KFT/stainless steel.
- 3. Convenient installation and removal by slide up/down the pump.

INSTALLING STEPS

- Step 1. connect a tube with mounting base, and make the base and upper guide rail positioning bracket fixed.
- Step 2. lift down the pump by guiding elbow and pulling chains.
- Step 3. steadily locate the pump to engage the base.



BF-B315 & Guide Rail FT-80B



KF4-455 & Guide Rail KFT-100E

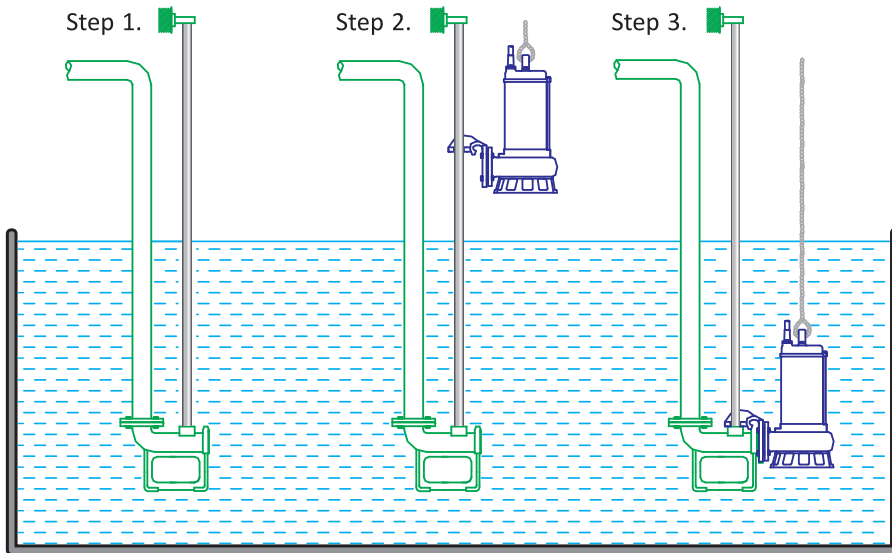

SPECIFICATIONS

Model	Material	Discharge (inch)	Fitted Pump (Hp)	Chain (m)	Guide Rail (inch)	Flange Type
FT-50	FC	2"	2P/ 0.5~1.5Hp	3m	1"	
FT-80B	FC	3"	2P/ 2~5Hp	4m	1½"	
FT-80A	FC	3¾"	2P/ 5~7.5Hp	4m	1½"	
FT-100E	FC	3¾"	2P/ 10~15Hp	4m	1½"	4" x 10K
	FC	3¾"	4P/ 3~15Hp	4m	1½"	4" x 10K
FT-150A	FC	6"	10~30Hp	4m	1½"	6" x 10K
FT-200	FC	8"	20~30Hp	4m	1½"	8" x 10K
KFT-50	SUS304	2"	2P/ 0.5~1.0Hp	3m	1"	
KFT-80A	SUS304	3¾"	2P/ 2~7.5Hp	4m	1½"	
KFT-100E	SUS304	3¾"	2P/ 10~15Hp	4m	1½"	4" x 10K
	SUS304	3¾"	4P/ 3~15Hp	4m	1½"	4" x 10K
KFT-150A	SUS316	6"	10~30Hp	4m	1½"	6" x 10K
KFT-200	SUS316	8"	20~30Hp	4m	1½"	8" x 10K

Accessories

- 1. Mounting base
- 2. Pump adapter
- 3. Upper guide rail positioning bracket
- 4. Stainless steel chains

Note:

Guide rails and pipe are not furnished.

※FT-150A, FT-200, KFT-150A, and KFT-200 without elbow.